



# Automatic Concealed Cistern Introduction





# Appearance

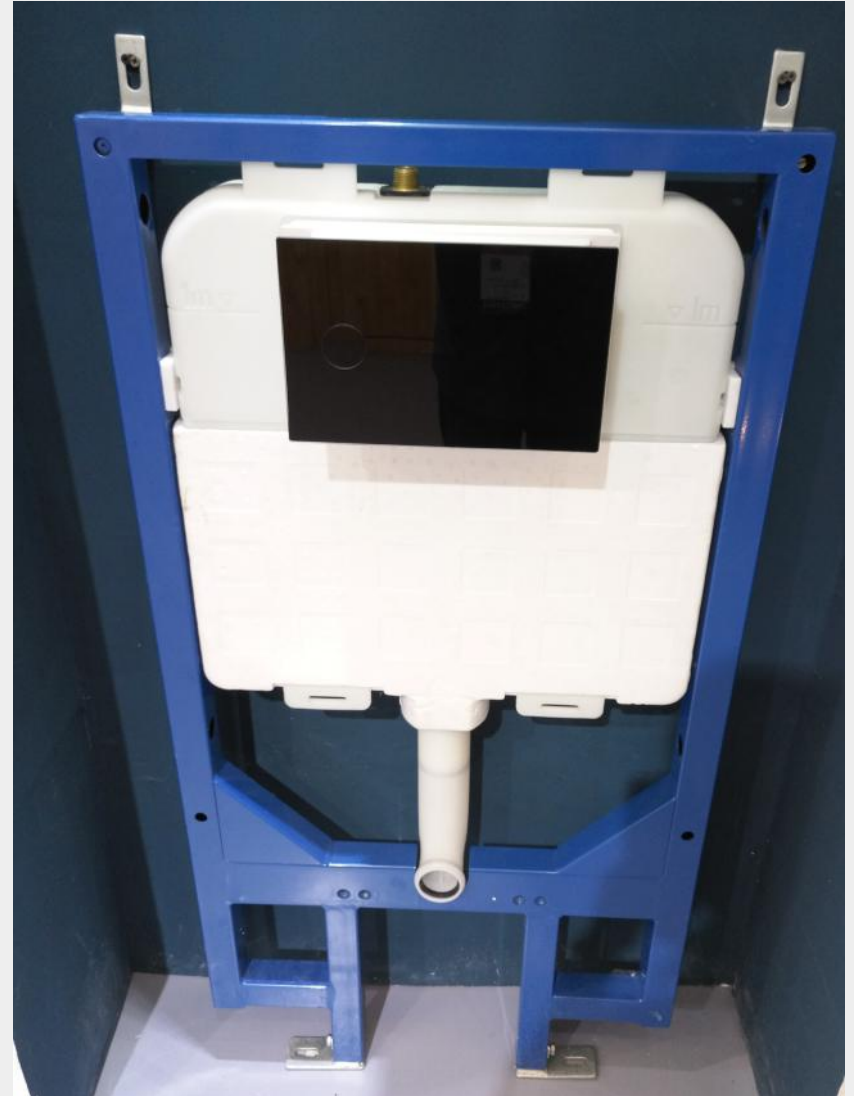
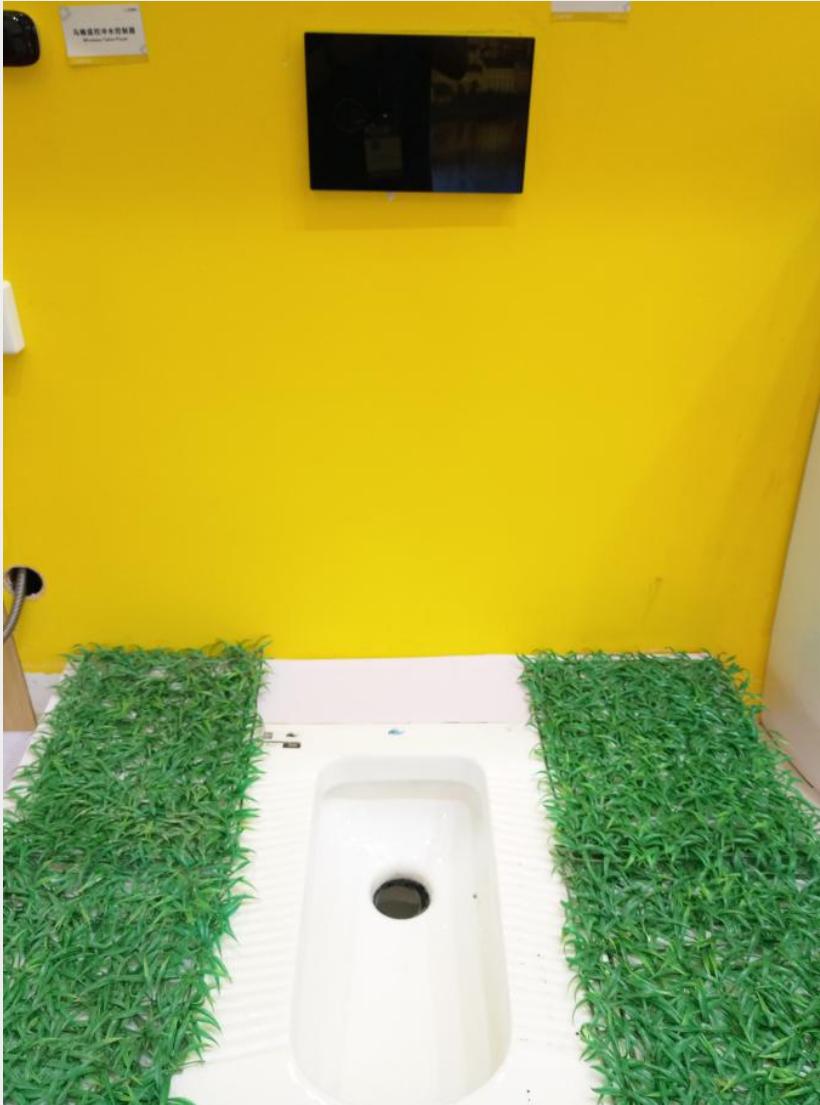



# Configuration



Sensor Panel



Water Tank  
(Short L-Shape Hose)  
Suitable for standing toilet

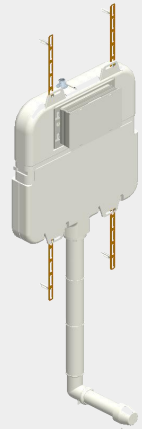

Water Tank  
(Long L-Shape Hose)  
Suitable for squat toilet

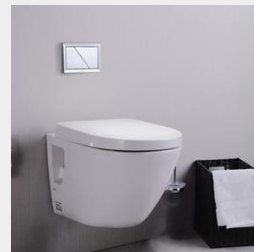

Water Tank and Iron Rack  
Suitable for wall mounted toilet



# Sensor Panel

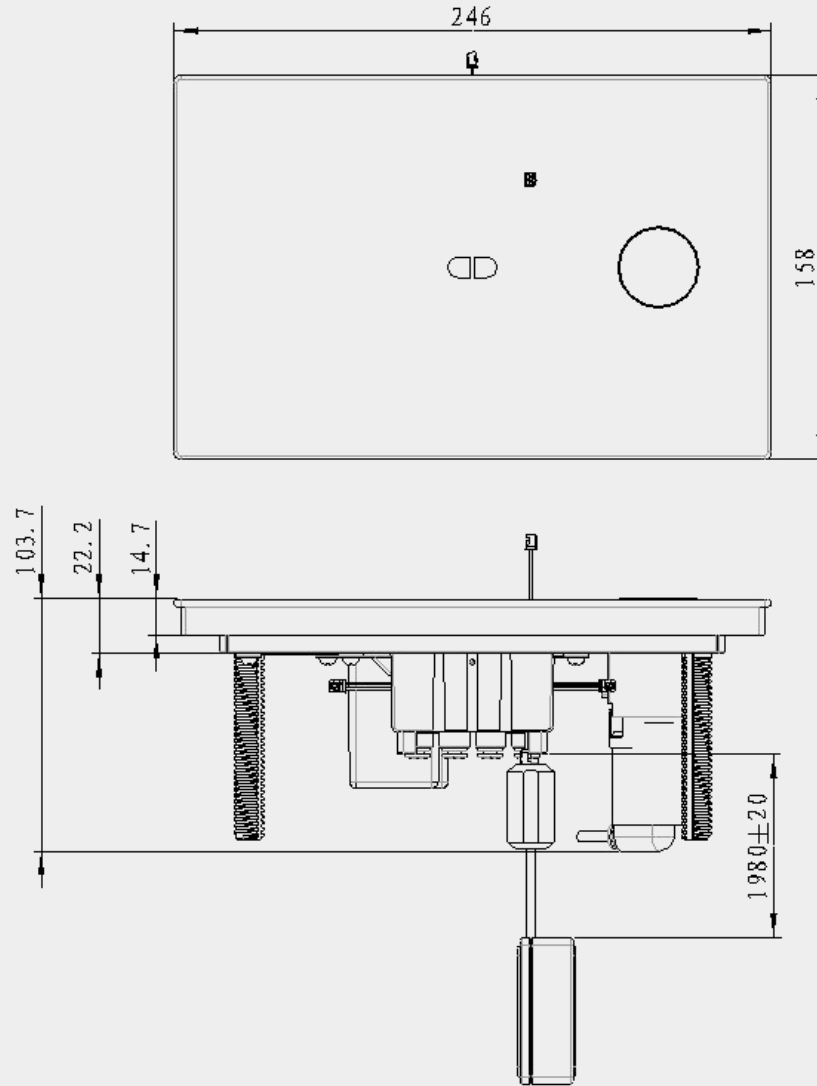



# Water Tank-1

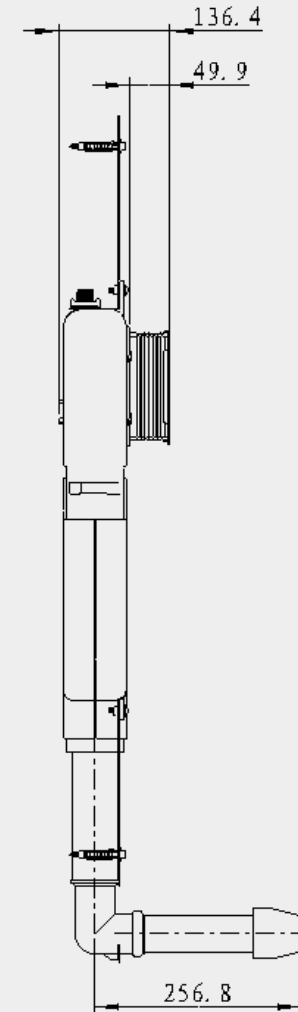
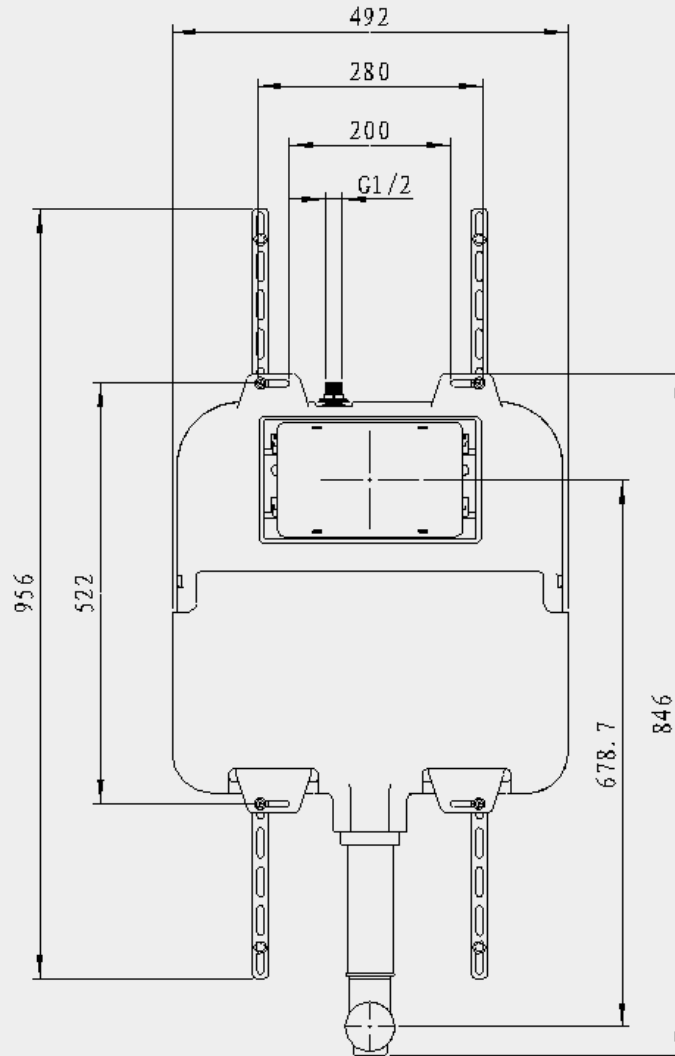



# Water Tank-2

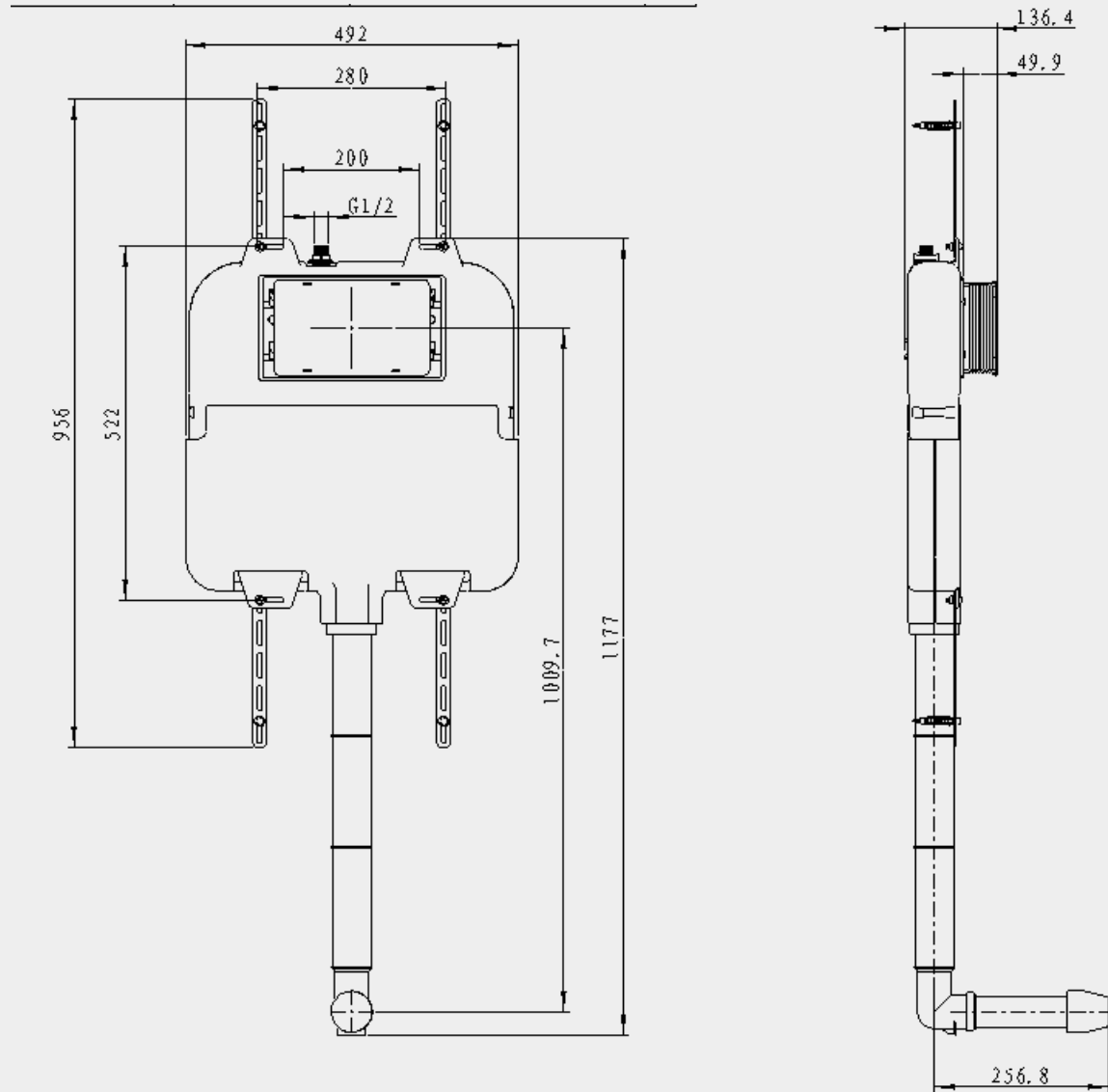



# Water Tank-3

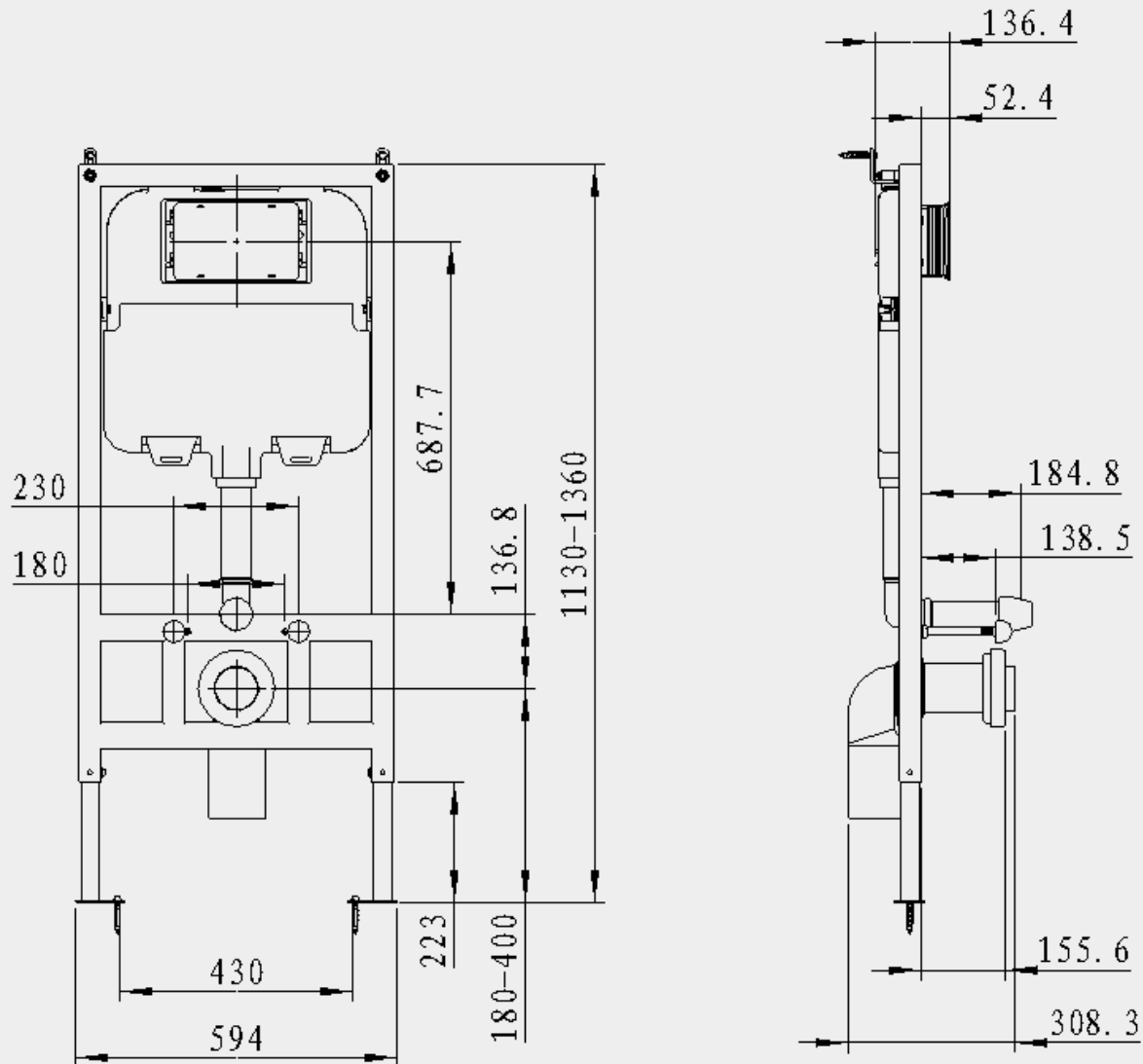





# Technical Parameters

General Information	
Model No.	RJY-32-G201D
Type	Automatic Concealed Cistern
Material	Tempered glass for sensor plate
The whole set Includes	1.Sensor Plate 2.Water Tank (RJY-32-SX01 ) 3.Iron Rack (RJY-32-TJ01 )
Weight	Product weight about 17KG Volume weight about 25KG
Warranty	One Year
Technical Parameters	
Working power	DC6V/AC220V
Average static power consumption	≤100uA
Instant dynamic power consumption	≤800uA
Working water pressure	Pneumatic
Sensor distance	650mm (30*30cm white board)
Water flow	2.5L/4.5 L or 3L/6 L
Low voltage	≤4.5±0.1
Waterproof grade	electrical parts IP65 whole unit IP55
Package Information	
Sensor plate	610*410*270mm; 8pcs/carton
Water tank and iron rack	1180*630*165mm; 1 set/carton





# Function-1



## Dual Flush Automatic Flush

The cistern will automatic flush after use. The sensor will distinguish timing and go for full flush as well as half flush. Using time more than 90 seconds, go for full flush while less than 90 seconds, go for half flush.

## LED Light Remind

- 1) Sensor LED will flash to remind you of replacing new batteries.
- 2) When the sensor is working, the backlight will light up on the logo location.





## Function-2



### Automatic Sensor and Manual Push Button

The concealed cistern is both sensor and manual override operated. The manual push button is stand-by. If the sensor is not working, you can press the pneumatic push button to activate water flush.

### Low Noise During Working

The cistern is low noise during working.





# Feature-1

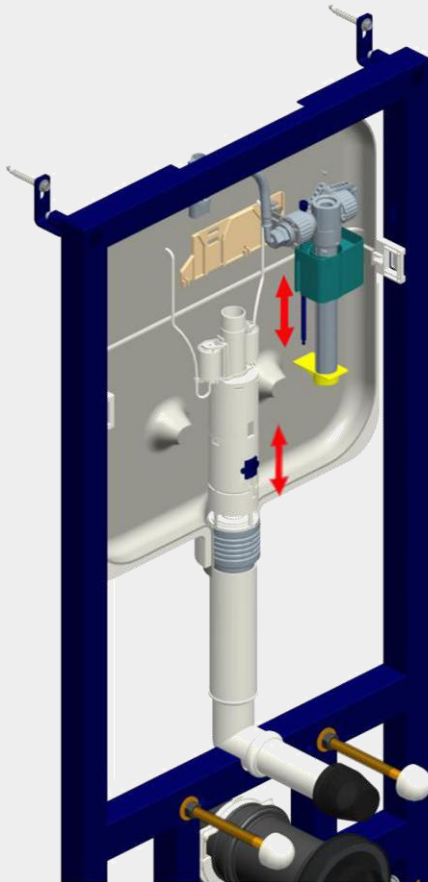

## Adjustable Water Flow

Adjustable water flow based on different working conditions and requirement. Adjustable water flow rate is 2.5L/4.5 L or 3L/6 L.

## Simple but Great

The concealed cistern saves space, making the space more concise, cleaning and more convenient.





## Feature-2

### Easy for Installation

The system is quite compact. It's easy for installation and maintenance.

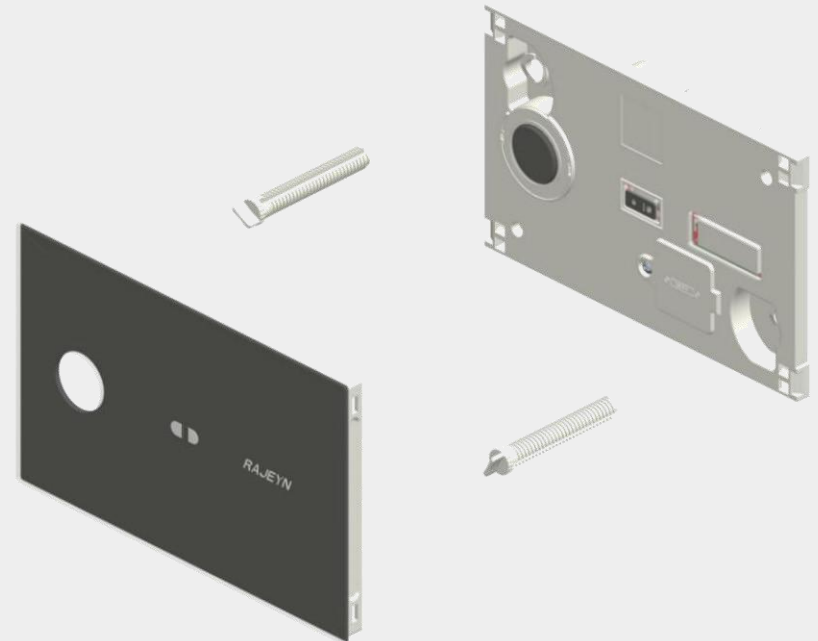
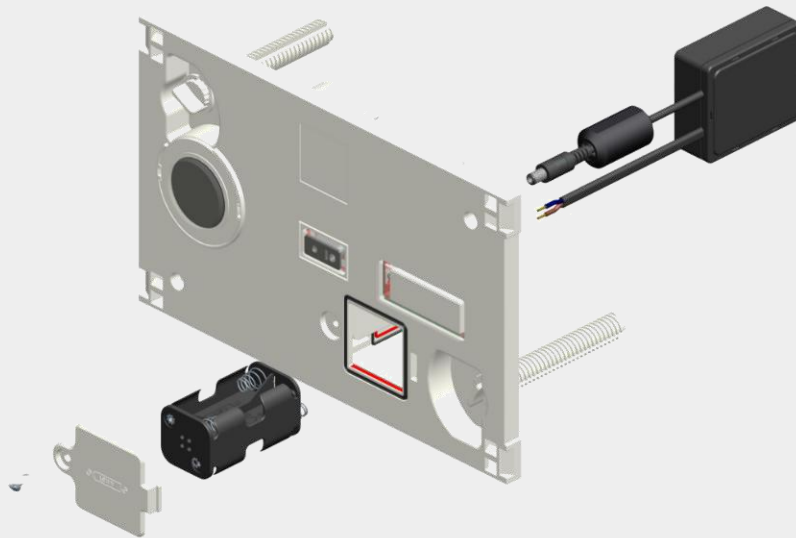

### Battery and Main Power Supply

Power supply is DC6V/AC220V. Optional either DC/AC or both.



**2021**

**Thank YOU**